

AM1 SERIES

FEATURES



- 35A continuous contact rating at 85°
- 1A (1PST) and 1C (1PDT) contact arrangement
- Small size (20.5x15x22mm) with high performance
- Using at air conditioner, electrical heater, remote-controlled TV, automatic control and household electric devices.

ORDERING INFORMATION

AM1 A — 12

1 2 3

- 1. Type
- 2. Contact Arrangement
Nil : 1 Form C
A : 1 Form A
- 3. Coil Nominal Voltage

CONTACT RATING

1 FORM A (SPST)	Resistive (Cos.θ = 1)	DC 14V	35A
1 FORM C (SPDT)	Resistive (Cos.θ = 1)	DC 14V	25A

COIL DATA(1.5W, at 25°C)

Coil Nominal Voltage (VDC)	Resistance Tol.10% (Ohms)	Nominal Current (mA)	Maximum Pick Up Voltage (V)	Minimum Drop Out Voltage (V)
12	96	122	8.4	1.2
24	384	61.7	16.8	2.4

DIMENSIONS(±0.2mm)

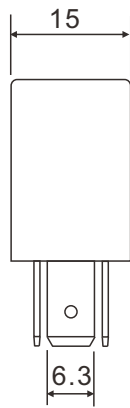
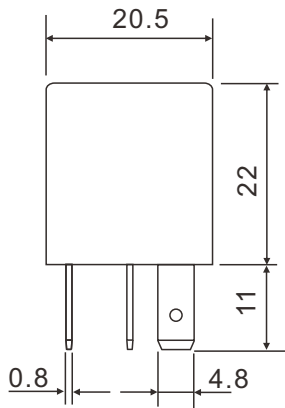

WIRING DIAGRAM (BOTTOM VIEW)

1 Form C

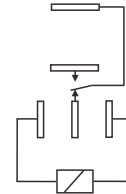

P.C.B LAYOUT (BOTTOM VIEW)

1 Form C

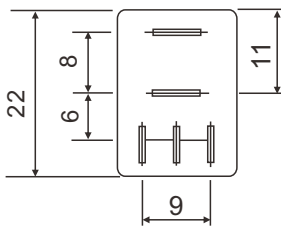

1 Form A

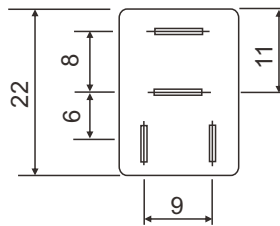

1 Form A

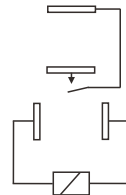

GENERAL DATA

Insulation Resistance	50 MΩ Min. (DC 500V)
Dielectric Strength	500 VAC, 50/60Hz between contact.
	500 VAC, 50/60Hz between all elements.
Contact Material	Ag Alloy.
Contact Resistance	100 milliohms max. (initial value)
Shock Resistance	Malfunction: 10G(11ms) ; Destructive: 100G(6ms)
Vibration Resistance	Malfunction: 10 to 55 Hz. at Double Amplitude of 1.5 mm
	Destructive: 10 to 55 Hz. at Double Amplitude of 1.5 mm
Operation Time	10 ms max.
Release Time	10 ms max.
Temperature Range	- 40°C ~ + 85°C
Expected Life	With operation rate 30/min.
	Mechanical - 10,000,000 operations min.
	Electrical - 100,000 operations min. at rated load.
Weight	20 grams

FEATURES

- 20A continuous contact rating at 85°
- 1A (1PST) and 1C (1PDT) contact arrangement
- Small size (20.5x15x22mm) with high performance
- Using at air conditioner, electrical heater, remote-controlled TV, automatic control and household electric devices.



ORDERING INFORMATION

AM1 A — 12

1 2 3

1. Type
2. Contact Arrangement
Nil : 1 Form C
A : 1 Form A
3. Coil Nominal Voltage

CONTACT RATING

1 FORM A (SPST)	Resistive (Cos.θ = 1)	DC 14V	20A
1 FORM C (SPDT)	Resistive (Cos.θ = 1)	NO:DC 14V / 20A	NC:DC 14V / 10A

COIL DATA(1.5W, at 25°C)

Coil Nominal Voltage (VDC)	Resistance Tol. 10% (Ohms)	Nominal Current (mA)	Maximum Pick Up Voltage (V)	Minimum Drop Out Voltage (V)
12	96	122	8.4	1.2
24	384	61.7	16.8	2.4

DIMENSIONS(±0.2mm)

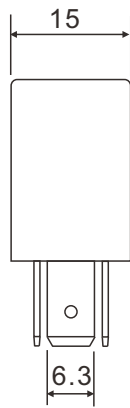
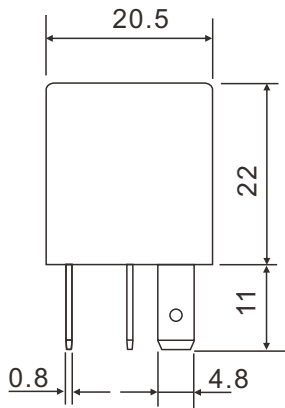

WIRING DIAGRAM (BOTTOM VIEW)

1 Form C

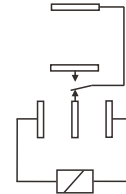

P.C.B LAYOUT (BOTTOM VIEW)

1 Form C

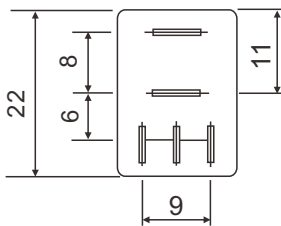

1 Form A

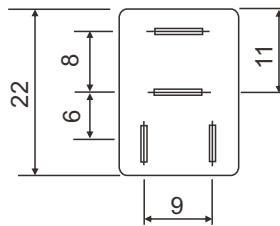

1 Form A

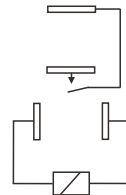

GENERAL DATA

Insulation Resistance	50 MΩ Min. (DC 500V)
Dielectric Strength	500 VAC, 50/60Hz between contact.
	500 VAC, 50/60Hz between all elements.
Contact Material	Ag Alloy.
Contact Resistance	100 milliohms max. (initial value)
Shock Resistance	Malfunction: 10G(11ms) ; Destructive: 100G(6ms)
Vibration Resistance	Malfunction: 10 to 55 Hz. at Double Amplitude of 1.5 mm
	Destructive: 10 to 55 Hz. at Double Amplitude of 1.5 mm
Operation Time	10 ms max.
Release Time	10 ms max.
Temperature Range	- 40°C ~ + 85°C
Expected Life	With operation rate 30/min.
	Mechanical - 10,000,000 operations min.
	Electrical - 100,000 operations min. at rated load.
Weight	20 grams

AM2 SERIES

FEATURES

- Contact rated load up to 30A/14VDC.
- Multiple choices for cover type.
- Coil enable parallel resistance reduce the operating power.
- Using at air condition control, halogen head lamp control, horn control, fog lamp control, etc.



ORDERING INFORMATION

AM2 — 12 P
 1 2 3

1. Type
 2. Coil Nominal Voltage
 3. Cover Type
 B : Non-Bracket
 P : Plastic Bracket

CONTACT RATING

1PST-NO	Resistive (Cos.θ = 1)	DC 14V	30A
---------	-----------------------	--------	-----

COIL DATA(1.8W, at 25°C)

Coil Nominal Voltage (VDC)	Resistance Tol.±10% (Ohms)	Nominal Current (mA)	Maximum Pick Up Voltage (v)	Minimum Drop Out Voltage (V)
12	80	150	8.4	1.2
24	320	75	16.8	2.4

DIMENSIONS(±0.2mm)

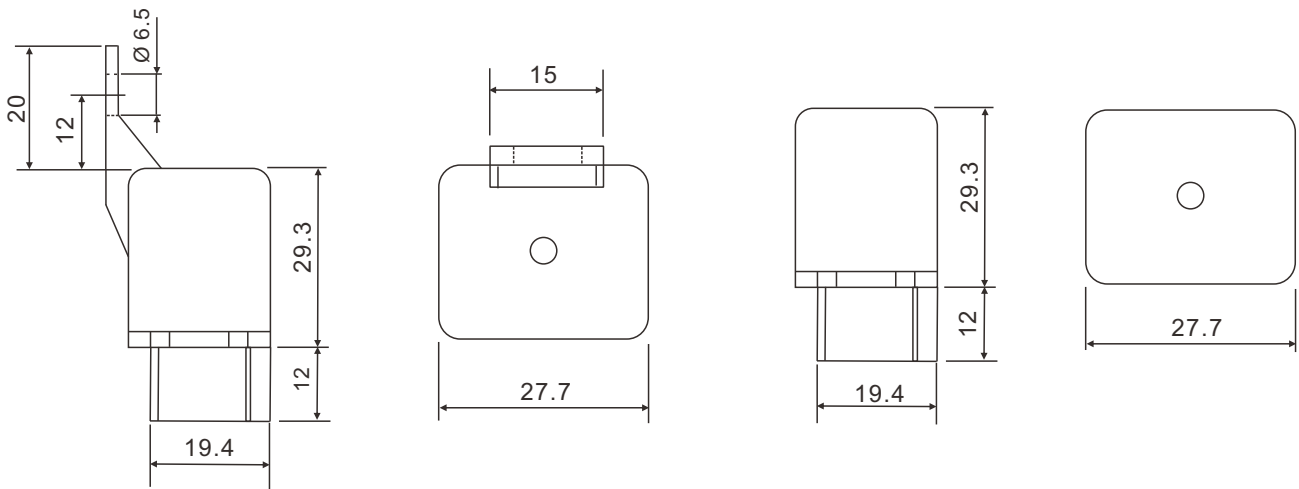

WIRING DIAGRAM
(BOTTOM VIEW)

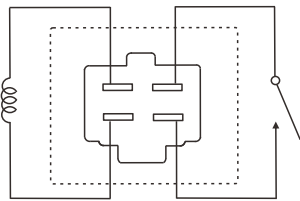

P.C.B LAYOUT
(BOTTOM VIEW)

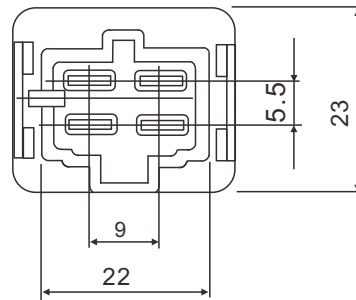

GENERAL DATA

Insulation Resistance	100 M Ω Min. (DC 500V)
Dielectric Strength	500 VAC, 50/60Hz between contact.
	750 VAC, 50/60Hz between all elements.
Contact Material	Ag alloy.
Contact Resistance	50 milliohms max. (initial value)
Shock Resistance	Malfunction: 10G(11ms) ; Destructive: 100G(6ms)
Vibration Resistance	Malfunction: 10 to 55 Hz. at Double Amplitude of 1.5 mm
	Destructive: 10 to 55 Hz. at Double Amplitude of 1.5 mm
Operation Time	10 ms max.
Release Time	10 ms max.
Temperature Range	- 40°C ~ + 85°C
Expected Life	With operation rate 30/min.
	Mechanical - 10,000,000 operations min.
	Electrical - 100,000 operations min. at rated load.
Weight	35 grams

FEATURES

- Plug-in/ PCB terminals are available for customer's selection.
- 60A/ 80A high current automotive relay
- 1A (1PST) contact form
- Using at automotive, direct connection with cell motors, transmission, and anti-locking braking system.



ORDERING INFORMATION

AM3 1A — 12 B P
1 2 3 4 5

- | | |
|-------------------------|-------------------------------|
| 1. Type | 4. Cover Type |
| 2. Contact Arrangement | P : Cover for Plastic Bracket |
| A : 1 Form A(1PST-NO) | B : Plastic Cover |
| Nil : 1 Form C(1PDT) | 5. Terminal Type |
| 3. Coil Nominal Voltage | Nil : Standard Type |
| | P : P.C.B. Terminal |

CONTACT RATING

1PDT	Resistive (Cos.θ = 1)	DC 14V	80A/60A
1PST-NO	Resistive (Cos.θ = 1)	DC 14V	80A

COIL DATA(1.8W, at 25°C)

Coil Nominal Voltage (VDC)	Resistance Tol.±10% (Ohms)	Nominal Current (mA)	Maximum Pick Up Voltage (v)	Minimum Drop Out Voltage (V)
6	18	333	3.6	0.6
12	72	167	7.2	1.2
24	288	83	14.4	2.4

DIMENSIONS (±0.2mm)

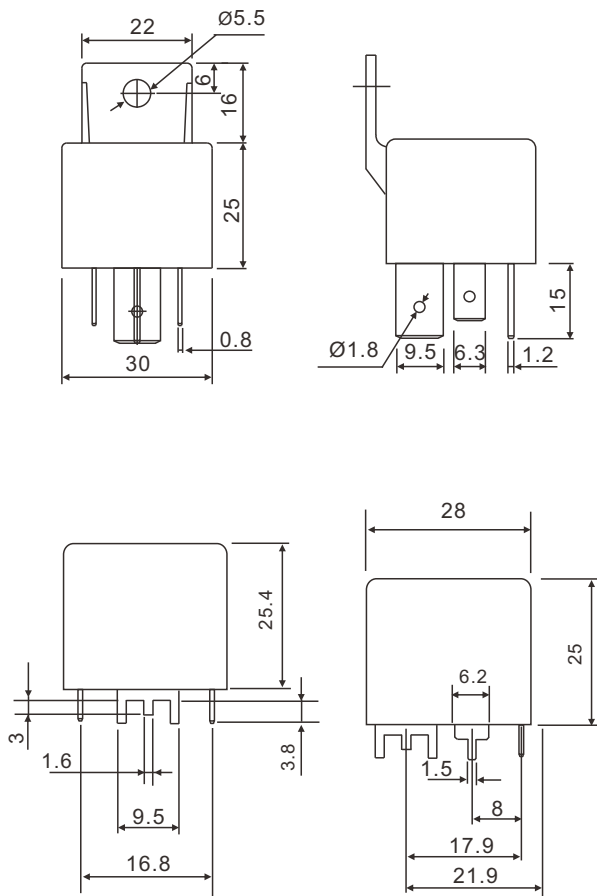

P.C.B LAYOUT
(BOTTOM VIEW)

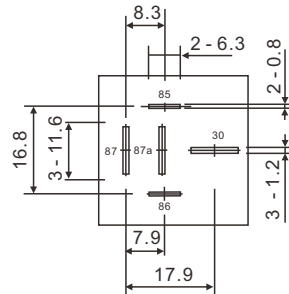

WIRING DIAGRAM
(BOTTOM VIEW)

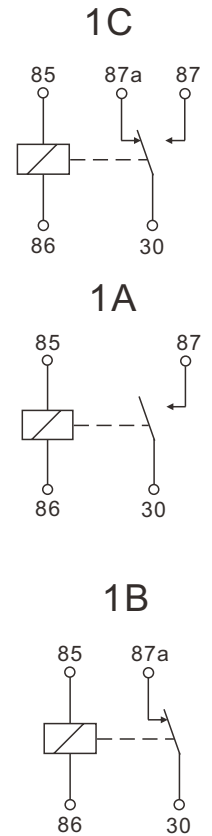

GENERAL DATA

Insulation Resistance	100 MΩ Min. (DC 500V)
Dielectric Strength	500 VAC, 50/60Hz between contact.
	500 VAC, 50/60Hz between all elements.
Contact Material	Ag Alloy.
Contact Resistance	50 milliohms max. (initial value)
Shock Resistance	Malfunction: 10G(11ms) ; Destructive: 100G(6ms)
Vibration Resistance	Malfunction: 10 to 55 Hz. at Double Amplitude of 1.5 mm
	Destructive: 10 to 55 Hz. at Double Amplitude of 1.5 mm
Operation Time	7 ms max.
Release Time	5 ms max.
Temperature Range	- 40°C ~ + 85°C
Expected Life	With operation rate 30/min.
	Mechanical - 10,000,000 operations min.
	Electrical - 100,000 operations min. at rated load.
Weight	41 grams

FEATURES

- Small size, light weight(4g).
- Withstands high temperature, operational under 105°C ambient temperature.
- Heavy contact load switching current up to 30A



ORDERING INFORMATION

AM6 — 12 T
1 2 3 4

- | | |
|------------------------|----------------------------|
| 1. Type | 3. Coil Nominal Voltage:12 |
| 2. Contact Arrangement | 4. T: Twin relay |
| Nil: 1Form C | |
| 1A: 1Form A | |

CONTACT RATING

1 FORM C (SPDT)	Resistive (Cos.θ = 1)	14 VDC	20A
1 FORM A (SPST)	Resistive (Cos.θ = 1)	14 VDC	20A

COIL DATA(0.6W, at 25°C)

Coil Voltage (VDC)	Resistance Tol.±10% (Ohms)	Nominal Current (mA)	Maximum Pick Up Voltage (V)	Minimum Drop Out Voltage (V)
12	240	50	8.4	1.2
24	960	25	16.8	2.4

DIMENSIONS(±0.2mm)

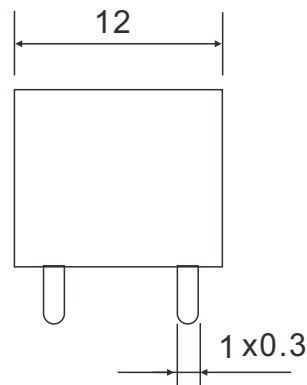
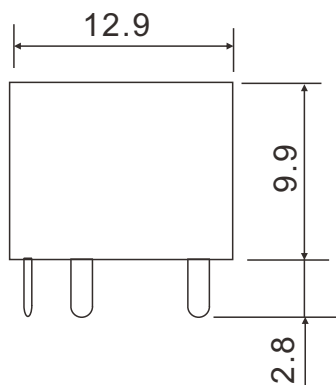

WIRING DIAGRAM
(BOTTOM VIEW)

P.C.B LAYOUT
(BOTTOM VIEW)

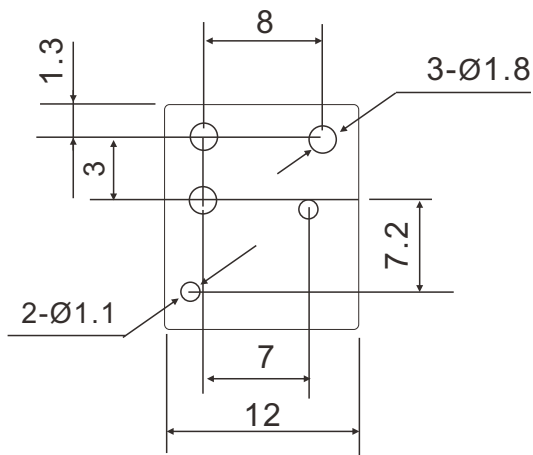
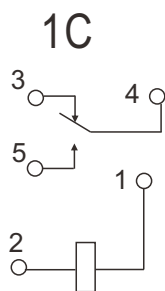
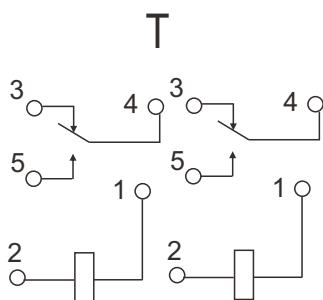

GENERAL DATA

Insulation Resistance	1000 MΩ Min. (DC 500V)
Dielectric Strength	500 VAC, 50/60Hz between contact.
	500 VAC, 50/60Hz between all elements.
Contact Material	Ag Alloy.
Contact Resistance	100 milliohms max. (initial value)
Shock Resistance	300m/s ² 6ms
Vibration Resistance	10~500Hz double amplitude 1.27 mm 60m/s ²
Temperature Range	- 40°C ~ + 105°C
Expected Life	With operation rate 30/min.
	Mechanical - 10,000,000 operations min. Electrical - 100,000 operations min. at rated load.
Weight	4 grams

FEATURES

- Open-frame and plastic sealed types
- European and USA footprints are available to meet international standards
- 1 Form A and 1 Form C contact arrangement

Using at automotive, control industrial , Domestic appliances, heavy loads, etc.

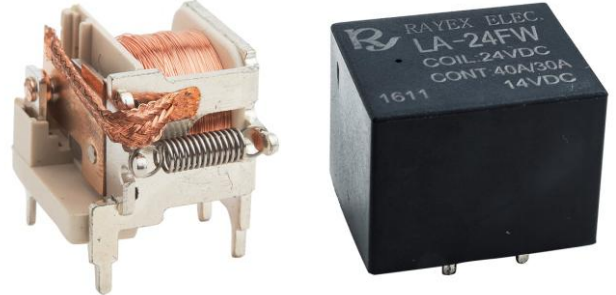

ORDERING INFORMATION

LA — 12 F W
 1 2 3 4 5 6

1. Type

2. Contact Arrangement

Nil:1 Form C

1A:1 Form A

1B:1 Form B

2A:2 Form A

3. Coil Nominal Voltage

4. Pin Position

F : USA footprint

E : European footprint

5. Coil Sensitivity

Nil : 1.6W

S : 1.2W

6. Enclosure

Nil : Open Type

W : Sealed Type

CONTACT RATING

1 Form C	Resistive (Cos.θ = 1)	DC 14V	40A/30A
2 Form A	Resistive (Cos.θ = 1)	DC 14V	2 x 20A

COIL DATA(1.2W,1.6W, at 25°C)

Coil Nominal Voltage (VDC)	Resistance Tol.±10% (Ohms)		Nominal Current (mA)		Maximum Pick Up Voltage (V)		Minimum Drop Out Voltage (V)
	1.6W	1.2W	1.6W	1.2W	1.6W	1.2W	
6	22.5	30	266.7	200	4.2	4.5	0.6
9	50.6	67.5	177.9	133.3	6.3	6.75	0.9
12	90	120	133.3	100	8.4	9.0	1.2
24	360	480	66.7	50	16.8	18.0	2.4

DIMENSIONS(±0.2mm)

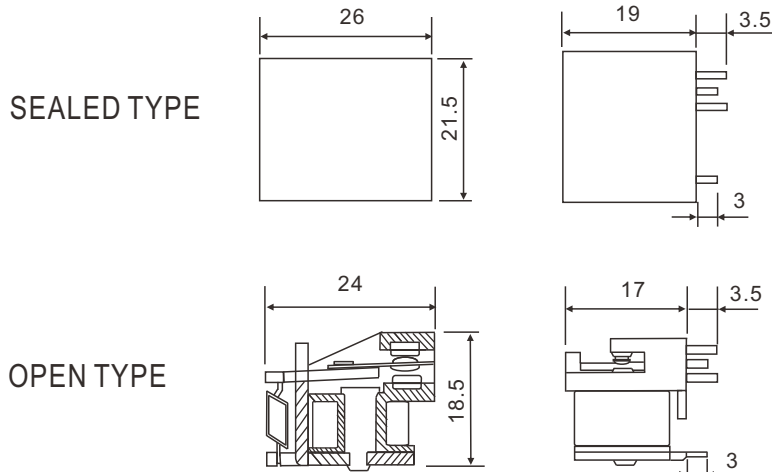

OPEN TYPE

SEALED TYPE

WIRING DIAGRAM (BOTTOM VIEW)

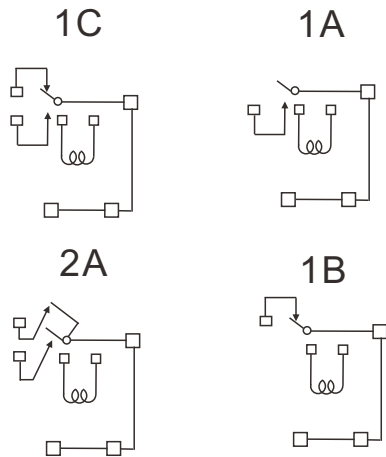

P.C.B LAYOUT (BOTTOM VIEW)

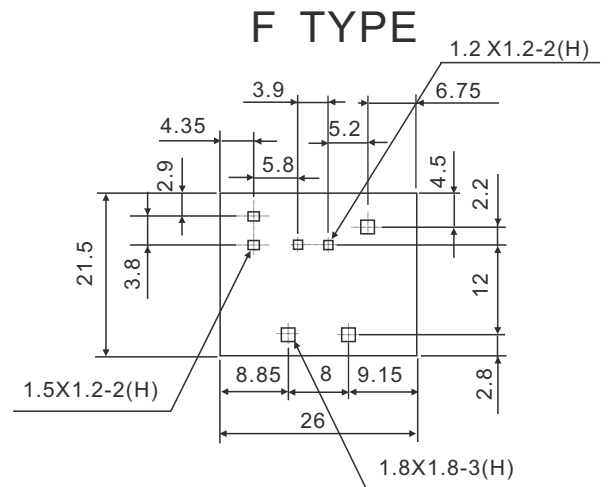

E TYPE

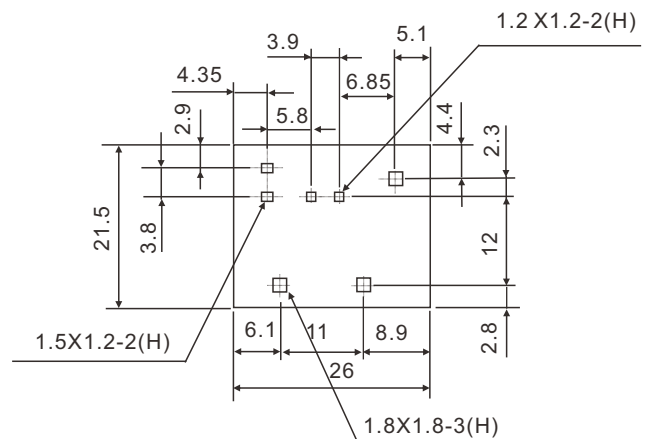

GENERAL DATA

Insulation Resistance	100 MΩ Min. (DC 500V)
Dielectric Strength	500 VAC, 50/60Hz between contact.
	1,000 VAC, 50/60Hz between all elements.
Contact Material	Ag Alloy.
Contact Resistance	100 milliohms max. (initial value)
Shock Resistance	Malfunction: 10G(11ms) ; Destructive: 100G(6ms)
Vibration Resistance	Malfunction: 10 to 55 Hz. at Double Amplitude of 1.5 mm
	Destructive: 10 to 55 Hz. at Double Amplitude of 1.5 mm
Operation Time	10 ms max.
Release Time	5 ms max.
Temperature Range	- 30°C ~ + 80°C
Expected Life	With operation rate 30/min.
	Mechanical - 10,000,000 operations min.
	Electrical - 100,000 operations min. at rated load.
Weight	17 grams

LDN SERIES

FEATURES

- 40A switching use relay at ambient temperature of 85°
- Solder lug (quick connect) and PCB terminals are available for customer's selection.
- Contact form: 1 form C, 1 Form B, 1 Form A, and 2 Form A
- Using at automotives, direct connection with cell motors, transmission, and anti-locking braking system.



ORDERING INFORMATION

LDN — 12 F

1 2 3 4 5 6

1. Type

2. Contact Arrangement

Nil : 1 Form C
 1A : 1 Form A
 1B : 1 Form B
 2A : 2 Form A

3. Coil Nominal Voltage

4. Cover Type

F : Cover for Steel Bracket
 P : Cover for Plastic Bracket
 B : Plastic Cover

5. Terminal Type

Nil : Standard Type
 P : PCB Terminal

6. Special Mark

Nil : Standard Type.

R : Coil parallel with 1/2W resistor 820Ω for 12VDC, 3200Ω for 24VDC.
 D1 : Coil parallel with diode 1N4007 the Positive pole "+" on # 85 terminal.
 D2 : Coil parallel with diode 1N4007 the Negative pole "-" on # 85 terminal.

CONTACT RATING

1 Form C	Resistive (Cos.θ = 1)	DC 14V	40A/30A
2 Form A	Resistive (Cos.θ = 1)	DC 14V	2 x 20A

COIL DATA(1.8W, at 25°C)

Coil Nominal Voltage (VDC)	Resistance Tol.±10% (Ohms)	Nominal Current (mA)	Maximum Pick Up Voltage (V)	Minimum Drop Out Voltage (V)
12	80	150	8.4	1.2
24	320	75	16.8	2.4

DIMENSIONS(±0.2mm)

F TYPE

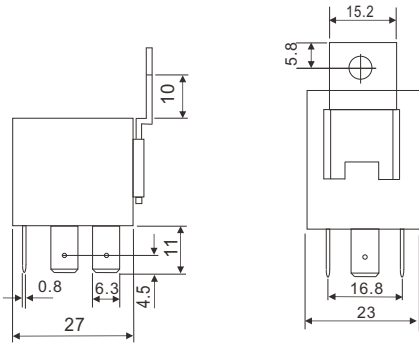

P TYPE

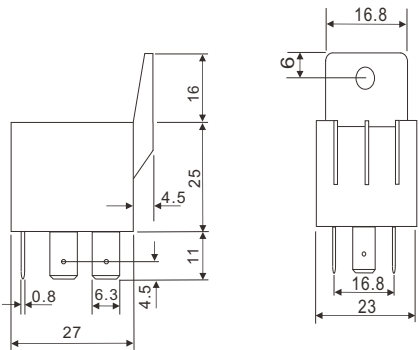

B TYPE

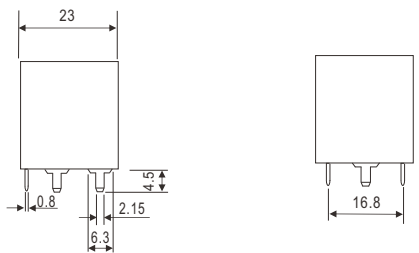

WIRING DIAGRAM
(BOTTOM VIEW)

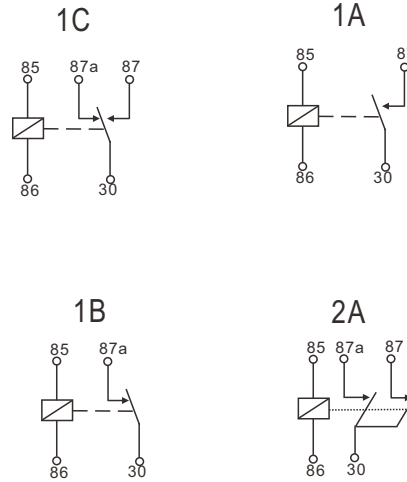

P.C.B LAYOUT
(BOTTOM VIEW)

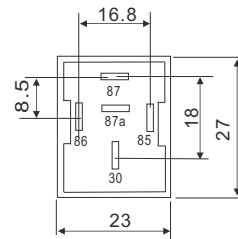

GENERAL DATA

Insulation Resistance	50 MΩ Min. (DC 500V)
Dielectric Strength	500 VAC, 50/60Hz between contact.
	1,000 VAC, 50/60Hz between all elements.
Contact Material	Ag Alloy.
Contact Resistance	100 milliohms max. (initial value)
Shock Resistance	Malfunction: 10G(11ms) ; Destructive: 100G(6ms)
Vibration Resistance	Malfunction: 10 to 55 Hz. at Double Amplitude of 1.5 mm
	Destructive: 10 to 55 Hz. at Double Amplitude of 1.5 mm
Operation Time	10 ms max.
Release Time	10 ms max.
Temperature Range	- 40°C ~ + 85°C
Expected Life	With operation rate 30/min.
	Mechanical - 1,000,000 operations min. Electrical - 100,000 operations min. at rated load.
Weight	33 grams

FEATURES

- 30A switching use relay at ambient temperature of 85°
- Solder lug (quick connect) and PCB terminals are available for customer's selection.
- Contact form: 1 form C, 1 Form B, 1 Form A, and 2 Form A
- Using at automotives, direct connection with cell motors, transmission, and anti-locking braking system.



ORDERING INFORMATION

LD ——— 12 F

1 2 3 4 5 6

1. Type

2. Contact Arrangement

Nil : 1 Form C
 1A : 1 Form A
 1B : 1 Form B
 2A : 2 Form A
 2AU

3. Coil Nominal Voltage

4. Cover Type

F : Cover for Steel Bracket
 P : Cover for Plastic Bracket
 B : Plastic Cover

5. Terminal Type

Nil : Standard Type
 P : PCB Terminal

6. Special Mark

Nil : Standard Type.

R : Coil parallel with 1/2W resistor 820Ω for 12VDC, 3200Ω for 24VDC.
 D1 : Coil parallel with diode 1N4007 the Positive pole "+" on # 85 terminal.
 D2 : Coil parallel with diode 1N4007 the Negative pole "-" on # 85 terminal.

CONTACT RATING

1 Form C	Resistive (Cos.θ = 1)	DC 14V	40A/30A
2 Form A	Resistive (Cos.θ = 1)	DC 14V	2 x30A

COIL DATA(1.8W, at 25°C)

Coil Nominal Voltage (VDC)	Resistance Tol.±10% (Ohms)	Nominal Current (mA)	Maximum Pick Up Voltage (V)	Minimum Drop Out Voltage (V)
5	14	357	3.5	0.5
12	80	150	8.4	1.2
24	320	75	16.8	2.4

DIMENSIONS(±0.2mm)

F TYPE

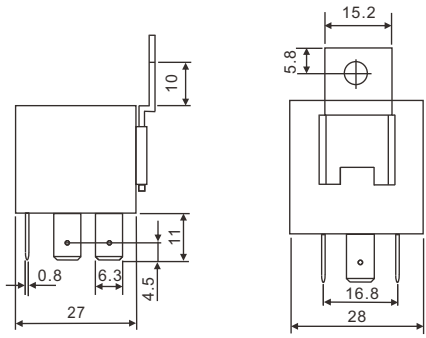

P TYPE

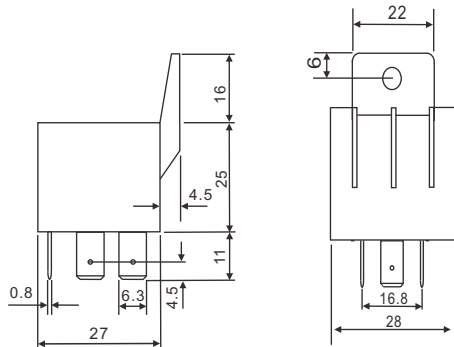

B TYPE

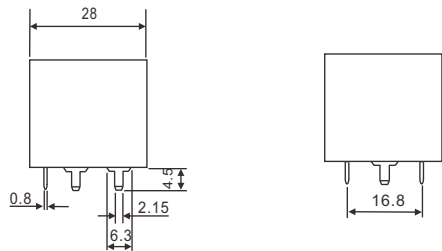

WIRING DIAGRAM (BOTTOM VIEW)

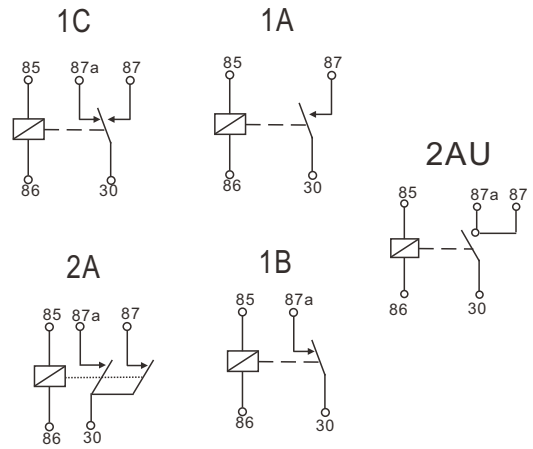

P.C.B LAYOUT (BOTTOM VIEW)

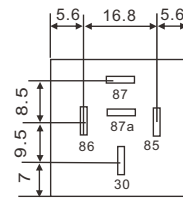

GENERAL DATA

Insulation Resistance	50 MΩ Min. (DC 500V)
Dielectric Strength	500 VAC, 50/60Hz between contact.
	1,000 VAC, 50/60Hz between all elements.
Contact Material	Ag Alloy.
Contact Resistance	100 milliohms max. (initial value)
Shock Resistance	Malfunction: 10G(11ms) ; Destructive: 100G(6ms)
Vibration Resistance	Malfunction: 10 to 55 Hz. at Double Amplitude of 1.5 mm
	Destructive: 10 to 55 Hz. at Double Amplitude of 1.5 mm
Operation Time	10 ms max.
Release Time	10 ms max.
Temperature Range	- 40°C ~ + 85°C
Expected Life	With operation rate 30/min.
	Mechanical - 1,000,000 operations min.
	Electrical - 100,000 operations min. at rated load.
Weight	32 grams

FEATURES

- 15A cube relay
- 1 Form C (1PDT) contact arrangement
- Plastic material applied in high temperature and better chemical solution.
- Sealed type for washing procedure
- Using at domestic appliances, office machines, audio equipment, coffee pot , control units, etc.



UL FILE NO. : E126157
 CUL FILE NO. : E126157
 TUV FILE NO. : R09754097

ORDERING INFORMATION

LEG 1A — 12 F L

1 2 3 4 5

- | | |
|-------------------------|------------|
| 1. Type | 5. L:0.80W |
| 2. Contact Arrangement | M:0.45W |
| Nil:1Form C(1PDT) | F :0.64W |
| 1A:1Form A(1PST-NO) | |
| 3. Coil Nominal Voltage | |
| 4. Contact Rating | |
| F: 15A,0.36W | |

CONTACT RATING

Resistive (Cos.θ = 1)	AC 120V / DC 24V	15A
-----------------------	------------------	-----

COIL DATA(0.36W,0.45W,0.8W,0.64W at 25°C)

Coil Nominal Voltage (VDC)	Resistance Tol.±10% (Ohms)				Nominal Current (mA)				Maximum Pick Up Voltage (V)	Minimum Drop Out Voltage (V)
	0.36W	0.45W	0.8W	0.64W	0.36W	0.45W	0.8W	0.64W		
3	25	20	11.3		120	150	265		2.1	0.3
5	70	55	31		72	90.9	161		3.5	0.5
6	100	80	45	56	60	75	133	107	4.2	0.6
9	225	180	101	127	40	50	89.1	70.8	6.3	0.9
12	400	320	180	225	30	37.5	66.6	53.3	8.4	1.2
24	1,600	1,280	740	900	15	18.5	32.4	26.7	16.8	2.4
48	6,400				7.5				33.6	4.8

DIMENSIONS(±0.2mm)

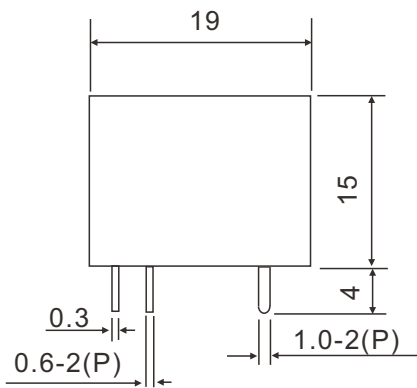

WIRING DIAGRAM
(BOTTOM VIEW)

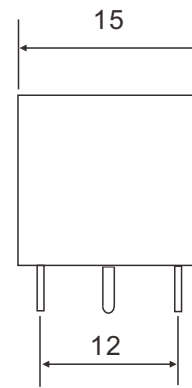

P.C.B LAYOUT
(BOTTOM VIEW)

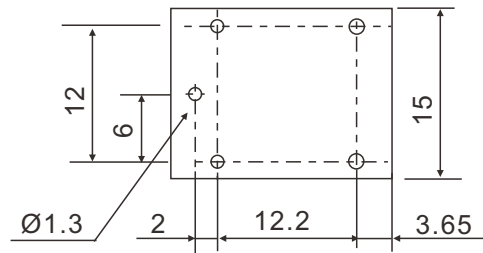
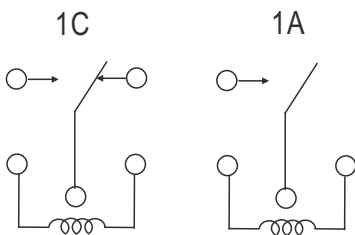

GENERAL DATA

Insulation Resistance	100 MΩ Min. (DC 500V)
Dielectric Strength	750 VAC, 50/60Hz between contact.
	1,500 VAC, 50/60Hz between all elements.
Contact Material	Ag Alloy.
Contact Resistance	100 milliohms max. (initial value)
Shock Resistance	Malfunction: 10G(11ms) ; Destructive: 100G(6ms)
Vibration Resistance	Malfunction: 10 to 55 Hz. at Double Amplitude of 1.5 mm
	Destructive: 10 to 55 Hz. at Double Amplitude of 1.5 mm
Operation Time	8 ms max.
Release Time	8 ms max.
Temperature Range	- 30°C ~ + 85°C
Expected Life	With operation rate 30/min.
	Mechanical - 10,000,000 operations min. Electrical - 100,000 operations min. at rated load.
Weight	9 grams

FEATURES

- 1 Form C contact arrangement
- 6g compact lightweight structure
- High resistance for vibration and shock
- Using at automotive, security systems, etc.



ORDERING INFORMATION

LQ

— 12
S

1
2
3
4

- | | |
|------------------------|-------------------------|
| 1. Type | 3. Coil Nominal Voltage |
| 2. Contact Arrangement | 4. Coil Sensitivity |
| Nil: 1 Form C | Nil : 0.8W |
| 1A: 1 Form A | S : 0.6W |
| 2A: 2 Form A | |

CONTACT RATING

1 Form C	Resistive (Cos.θ = 1)	14 VDC	20A
2 Form A	Resistive (Cos.θ = 1)	14 VDC	10A

COIL DATA(0.6W,0.8W, at 25°C)

Coil Nominal Voltage (VDC)	Resistance Tol. ±10% (Ohms)		Nominal Current (mA)		Maximum Pick Up Voltage (V)	Minimum Drop Out Voltage (V)
	0.8W	0.6W	0.8W	0.6W		
6	45	60	133.4	100.0	3.6	0.6
9	100	135	90.0	66.7	5.4	0.9
12	180	240	66.7	50.0	7.2	1.2
24	720	960	33.3	25.0	14.4	2.4

DIMENSIONS(±0.2mm)

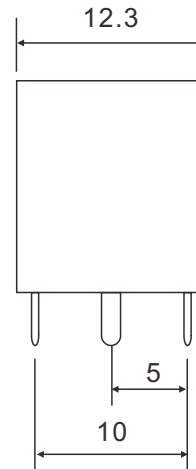
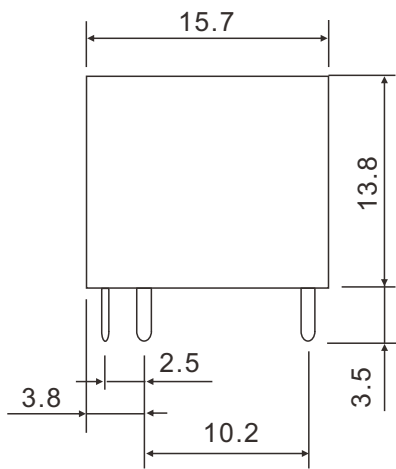

**WIRING DIAGRAM
(BOTTOM VIEW)**

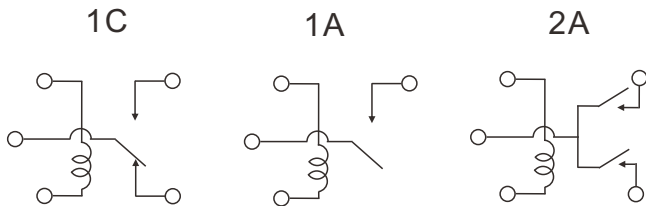

**P.C.B LAYOUT
(BOTTOM VIEW)**

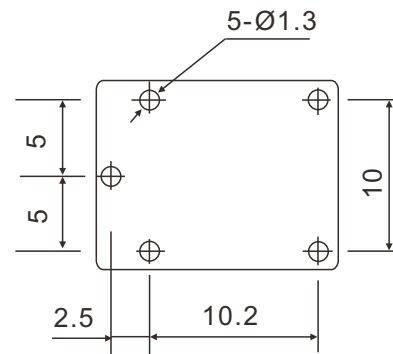

GENERAL DATA

Insulation Resistance	100 MΩ Min. (DC 500V)
Dielectric Strength	500 VAC, 50/60Hz between contact.
	1,000 VAC, 50/60Hz between all elements.
Contact Material	Ag Alloy.
Contact Resistance	100 milliohms max. (initial value)
Shock Resistance	Malfunction: 10G(11ms) ; Destructive: 100G(6ms)
Vibration Resistance	Malfunction: 10 to 55 Hz. at Double Amplitude of 1.5 mm
	Destructive: 10 to 55 Hz. at Double Amplitude of 1.5 mm
Operation Time	10 ms max.
Release Time	5 ms max.
Temperature Range	- 40°C ~ + 85°C
Expected Life	With operation rate 30/min.
	Mechanical - 10,000,000 operations min.
	Electrical - 100,000 operations min. at rated load.
Weight	6 grams

FEATURES

- Up to 15A for exclusive automobile control relay switching box use
- Open-frame and sealed type are available
- Contact form: 1 form A, 2 form A
Using at automotive, security systems, etc

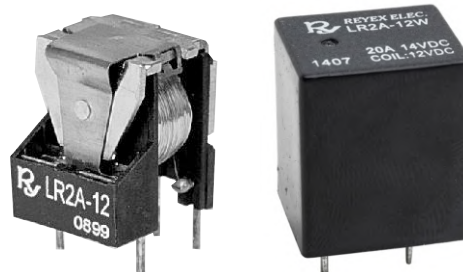

ORDERING INFORMATION

LR 1A — 12 W
 1 2 3 4

- | | |
|------------------------|-------------------------|
| 1. Type | 3. Coil Nominal Voltage |
| 2. Contact Arrangement | 4. Enclosure |
| 1A : 1 Form A | Nil : Open Type |
| 2A : 2 Form A | W : Sealed Type |

CONTACT RATING

1 Form A	Resistive (Cos.θ = 1)	DC 14 V	15A
2 Form A	Resistive (Cos.θ = 1)	DC 14 V	2 x 10A

COIL DATA(1.1W, at 25°C)

Coil Nominal Voltage (VDC)	Resistance Tol.±10% (Ohms)	Nominal Current (mA)	Maximum Pick Up Voltage (V)	Minimum Drop Out Voltage (V)
6	33	182	3.6	0.6
12	130	92	7.2	1.2
24	520	46	14.4	2.4

DIMENSIONS(±0.2mm)

SEALED TYPE

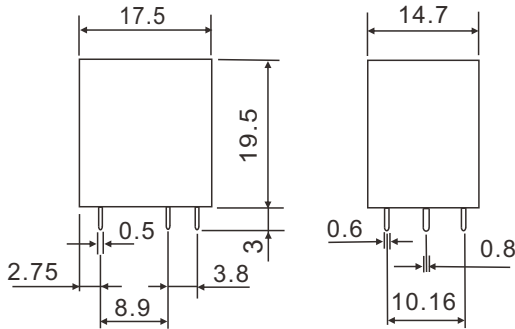

OPEN TYPE

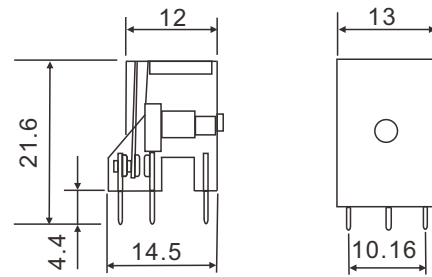

WIRING DIAGRAM
(BOTTOM VIEW)

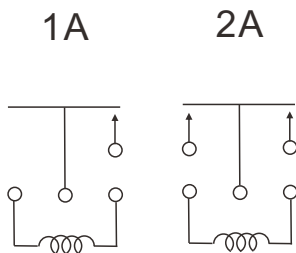

P.C.B LAYOUT
(BOTTOM VIEW)

SEALED TYPE

OPEN TYPE

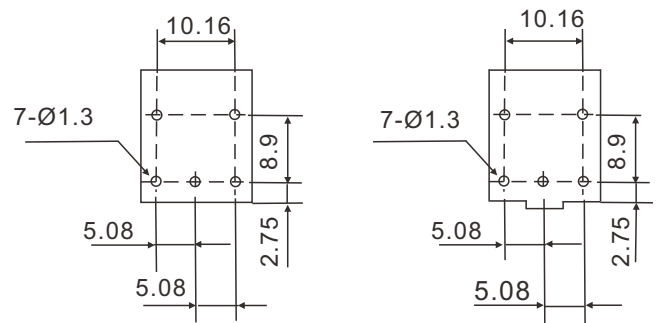

GENERAL DATA

Insulation Resistance	100 MΩ Min. (DC 500V)
Dielectric Strength	750 VAC, 50/60Hz between contact.
	500 VAC, 50/60Hz between all elements.
Contact Material	Ag Alloy.
Contact Resistance	100 milliohms max. (initial value)
Shock Resistance	Malfunction: 10G(11ms) ; Destructive: 100G(6ms)
Vibration Resistance	Malfunction: 10 to 55 Hz. at Double Amplitude of 1.5 mm
	Destructive: 10 to 55 Hz. at Double Amplitude of 1.5 mm
Operation Time	6 ms max.
Release Time	3 ms max.
Temperature Range	- 40°C ~ + 85°C
Expected Life	With operation rate 30/min.
	Mechanical - 10,000,000 operations min.
	Electrical - 100,000 operations min. at rated load.
Weight	12 grams